

## INSTALLATION INSTRUCTIONS

DESCRIPTION: Swing Arm Spool (Various Colors)

PART NUMBER: BN6-F21B0-XX

MODEL: '18~ YZF-R6



### **⚠ WARNING**

Please read and understand these instructions completely before installation to avoid possible injury, or damage to the accessory or vehicle.

### WARRANTY INFORMATION:

In the United States, see your Yamaha dealer for a copy of the Yamaha Genuine Parts & Accessories limited warranty statement.

### NOTICES:

This installation requires a torque wrench and should be performed by an authorized Yamaha dealer or other qualified technician.

### DEALER OR INSTALLER:

These instructions contain important information for future reference and *must* be given to the customer.

### PARTS LIST:

No.	Part Number	Description	Qty
--	BN6-F21B0-XX	Swing Arm Spool Kit	--
①	*	Swing Arm Spool	2
②	*	Socket head bolt, M6 x 40mm	2

\* Part supplied with kit only and not available separately.

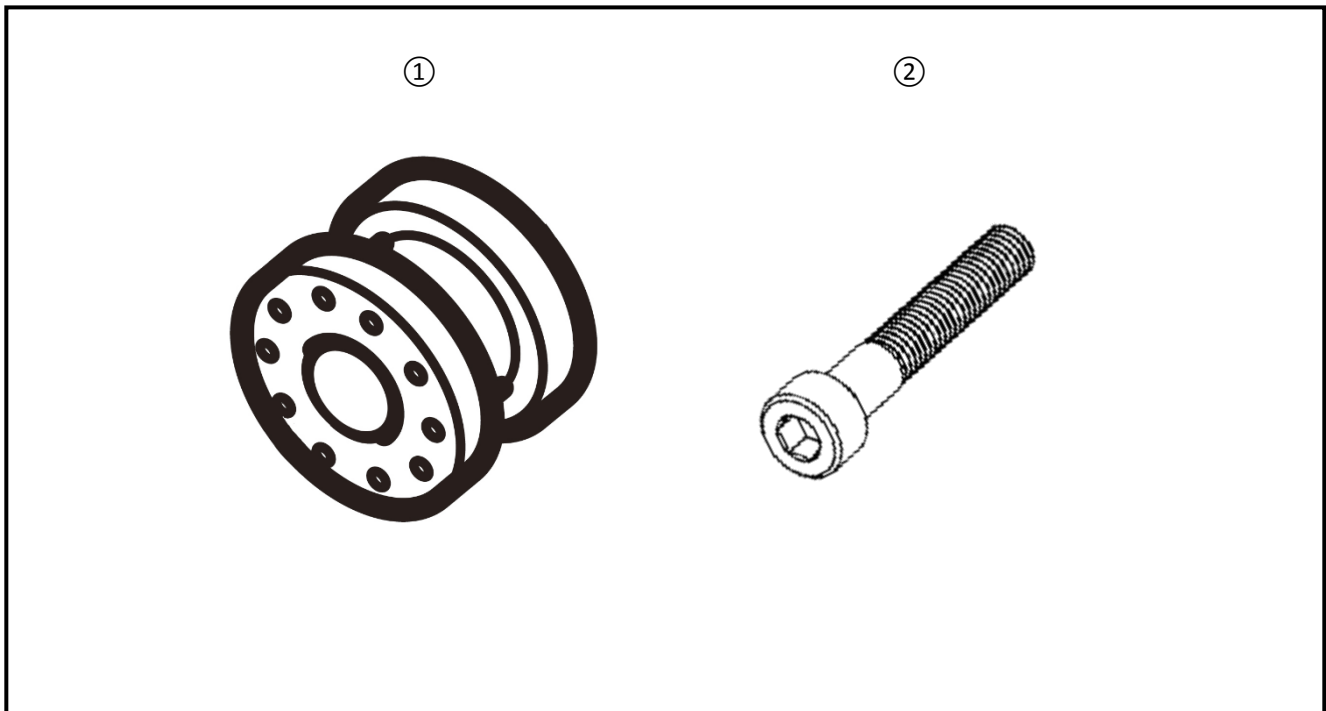

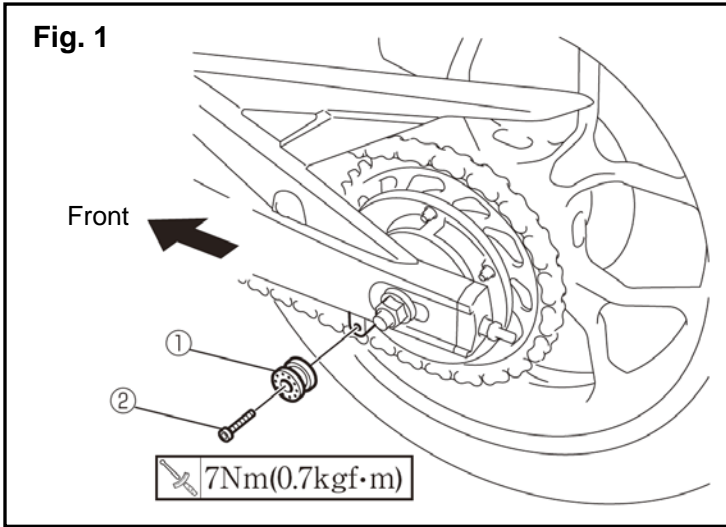

**PREPARATION:**

Stand motorcycle on a secure and level surface. Clean all mounting surfaces before beginning installation.

**INSTALLATION:**

1. Install Swing Arm Spool ① onto left side of swing arm with bolt ② as shown in Fig. 1.
2. Torque bolt to 5 ft-lb (7Nm).
3. Repeat for right side.

**MAINTENANCE:**

Periodically, check torque on all hardware. If loose hardware is found, re-torque to specification.

**CARE AND CLEANING:**

Clean with a soft cloth and mild soap and water solution.

**CUSTOMER SERVICE:**

For further information see your Yamaha dealer.

**ESTIMATED TIME TO INSTALL: 0.1 HRS**